

SOLO4

PRODUCT
SPECIFICATION
GUIDE

CCL
WETROOMS

SECTION I - SOLID FLOOR DRAINS

I.1 PRODUCT INFORMATION

I.2 LINEAR DRAINS

A) LINEAR SCREED DRAIN

B) LINEAR SCREED LINE

I.3 FLOOR BUILD UP

A) HI-BUILD LATEX

B) LINEAR SCREED-DEC

I.4 SOLO4

I.1

I.2 a

I.2 b

I.3 a

I.3 b

I.4

PRODUCT
SPECIFICATION
GUIDE

CHOOSE LAYOUT

ONE-WAY FALL

Having a single one-way fall has some significant advantages in both the design and installation of a wetroom shower.

The linear drain is neatly positioned up against the wall, ensuring a sleek, unobtrusive finish, whilst at the same time making it simple to create the gradient using our pre-formed Linear Screed-Dec.

It is also simple to tile, especially when using large format tiles, with no difficult or unsightly cuts required around the drain.

List of products to achieve one-way fall

Drainage - see section 1.2 for full details

- Linear Screed Drain
- Linear Screed Line

Floor build-up - see section 1.3 for full details

- Linear Screed-Dec
- HBL-50 Hi-Build Latex

FAST TRACK bespoke service available - delivered in 3-4 days.

Drain positioned against the long wall.

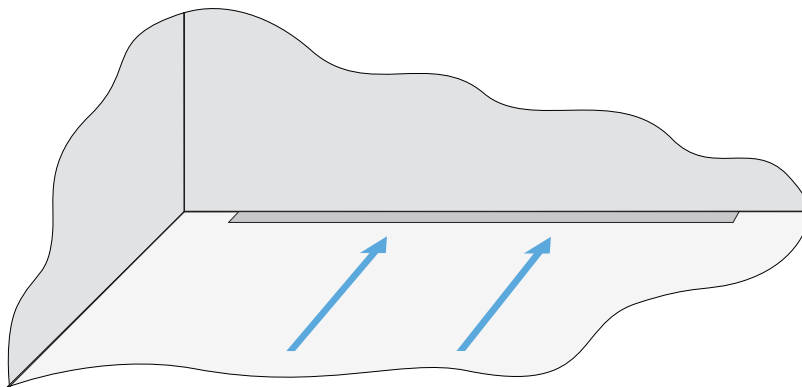

Drain positioned against the short wall.

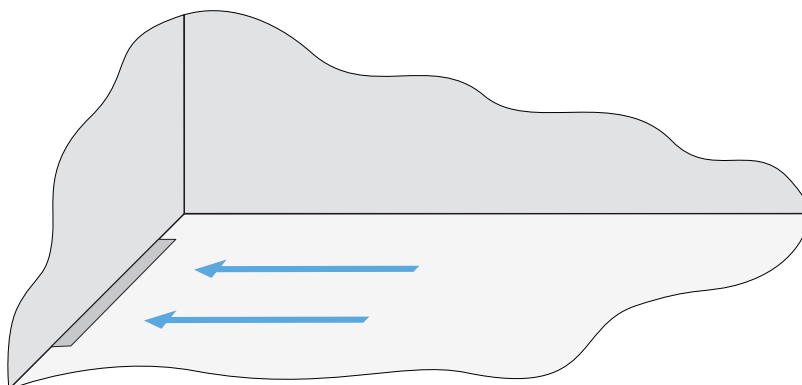



SOLID
FLOOR

I.I

PRODUCT INFORMATION

CHOOSE LAYOUT

TWO-WAY FALL

With the linear drain positioned off the wall, a two-way fall design maintains a sleek look with the gradient formed in two directions, either side the drain.



THREE-WAY FALL

With the linear drain positioned against the wall, the gradient is formed in three directions towards the drain. Suitable for larger showers exceeding 2000mm and walk-through shower areas.



FOUR-WAY FALL

With the single point drain positioned within the shower area, the gradient is formed in four directions towards the drain. Best suited for mosaic tiles.



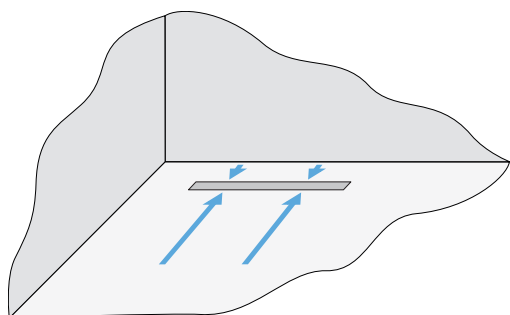

List of products to achieve two-way fall

Drainage - see section 1.2 for full details

- Linear Screed Drain
- Linear Screed Line

Floor build-up - see section 1.3 for full details

- Linear Screed-Dec
- HBL-50 Hi-Build Latex

FAST TRACK bespoke service available - delivered in 3-4 days.

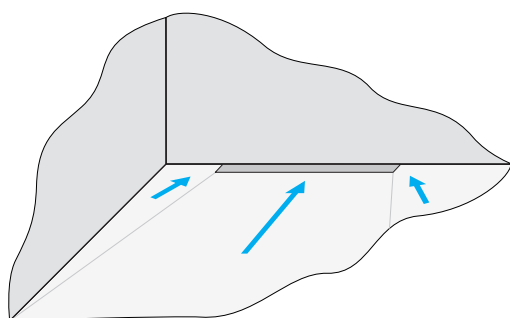

List of products to achieve three-way fall

Drainage - see section 1.2 for full details

- Linear Screed Drain
- Linear Screed Line

FAST TRACK bespoke service available - delivered in 3-4 days.

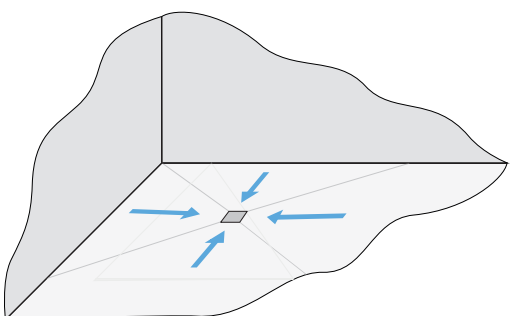

List of products to achieve four-way fall

Drainage - see section 1.4 for full details

- Solo4

SOLO4 TILED

Solo4 is a 50mm waterseal shower gully, ideal for use in solid floors of all types.

Designed for tiled floors it is available in a choice of stylish grill finishes with the option a horizontal or vertical outlet.

Suitable for use in commercial and domestic wetrooms, barrier free showering, retirement and care homes, student accommodation, hotels and leisure, backed by our Lifetime Guarantee.



SOLID
FLOOR

I.4

SOLO4 TILED

INTRODUCTION

SOLID
FLOOR

MINIMUM HEIGHT:

STANDARD
BRACKETS: 138mm

EXTRA SHALLOW
BRACKETS: 38mm

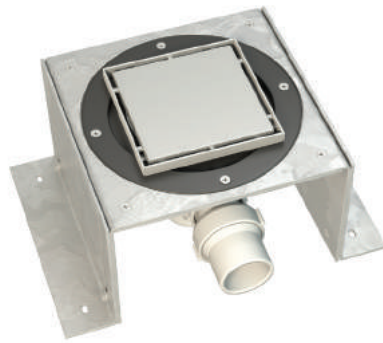

The Solo4 has been designed for concrete or screeded floors for use on concrete slabs, planks and block and beam floors. Available with either a horizontal or vertical outlet, the drain incorporates our TR-50 trap which

has a 50mm waterseal and is supported by a lifetime guarantee. Designed for use with tiled floors, it is available with a choice of stylish grill finishes, to suit almost any application.

KEY FEATURES

- Horizontal or Vertical Outlet
- 50mm Waterseal trap EN274-1:2002
- Flow rate up to 24 L/min
- Lifetime Guarantee
- Minimum height 38mm with Extra Shallow Brackets
- Minimum height 138mm with Std. Brackets
- 360° Rotatable outlet
- Adjustable trap outlet
- Height adjustable brackets
- Height adjustable grill and choice of finishes

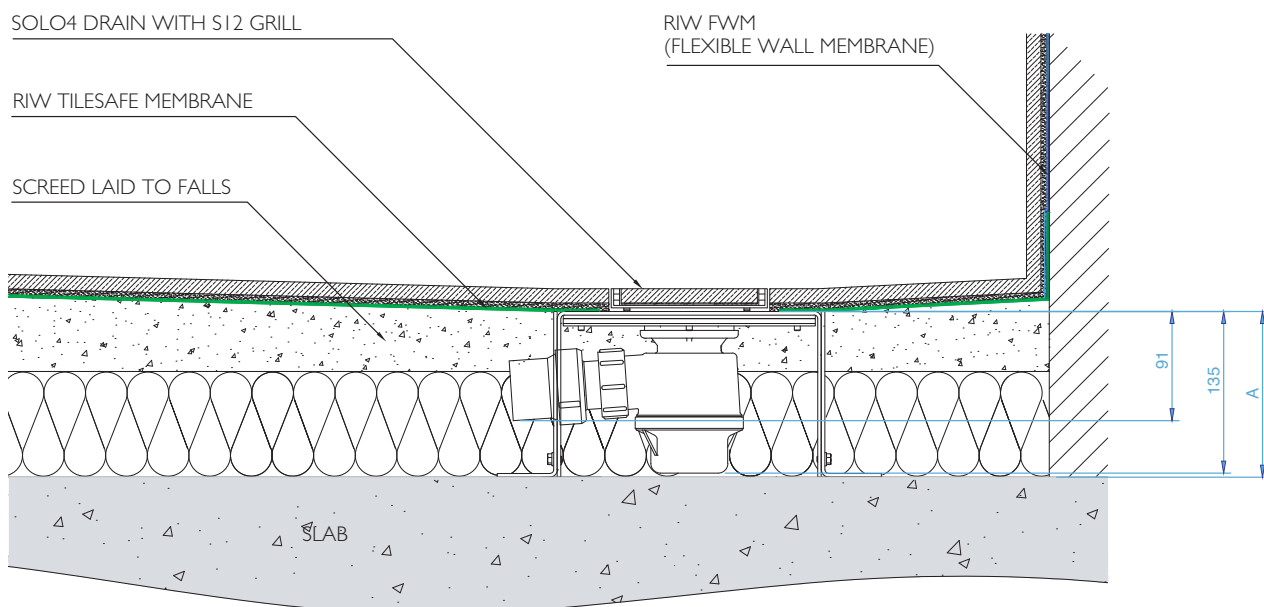

DIMENSION A : MIN. 138mm MAX. 255mm (Extension brackets available) drawn as 150mm.

SOLO4 TILED

HOW TO BUILD YOUR DRAIN

Start with the bracket type, selecting the required height, then choose the outlet position, horizontal or vertical. To finish simply add the desired choice of grill.

DRAIN BODY



Type of trap

- Horizontal Outlet
- Vertical Outlet

See page 7 for full details

Bracket type

- Standard Height
- Extra Shallow Height

See below for full details

I.4

BRACKET TYPE

HORIZONTAL TRAP

Standard Bracket

Adjustable between 138mm - 255mm.

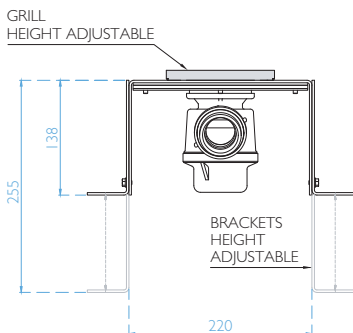

VERTICAL TRAP

(available in two options)

Standard Bracket

Adjustable between 55mm - 89mm.

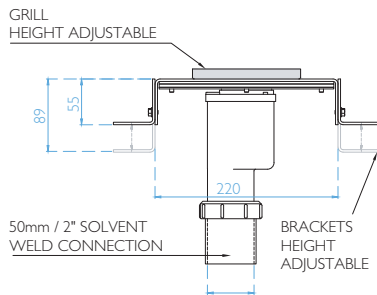

Extra Shallow Bracket

Adjustable between 38mm - 57mm.

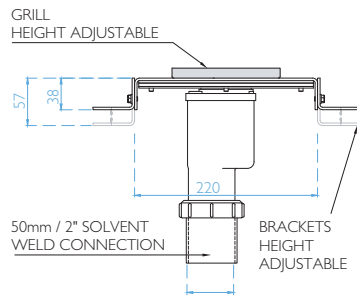

See page 9 for product codes.

TRAP OUTLETS

HORIZONTAL TRAP

The horizontal trap incorporates an adjustable ball joint, allowing for ease of installation and is accessible from the top for cleaning and maintenance.

- 50mm Waterseal
- 40mm ABS pipe connection

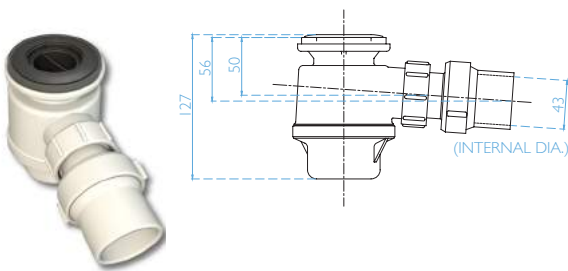

VERTICAL TRAP

The vertical trap allows the outlet to be positioned through the slab and connected to a waste pipe below and is accessible from the top for cleaning and maintenance.

- 50mm Waterseal
- 50mm ABS pipe connection

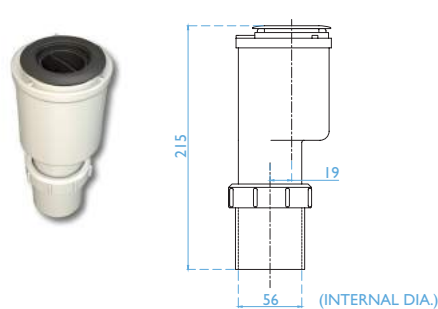

GRILL FINISH

The grill is available in various different finishes.

All are manufactured in 316 marine grade stainless steel, ensuring a stunning high quality finish.

Type A - Solid Grill is supplied as standard unless otherwise specified.

Type A - Solid

Grained stainless steel with a 3mm gap around the grill for a sleek stylish finish.

TYPE A



Type B - Slotted

Oblong Slots with a brushed stainless steel finish.

TYPE B



Type S12 - Stone-Infill

Stone-Infill grill allows a section of matching stone or tile to be inserted, providing contemporary continuous look.

Suits 10-12mm tile thickness.

TYPE S12

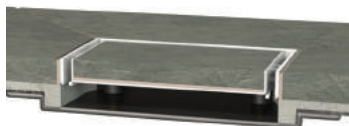

See page 9 for product codes.

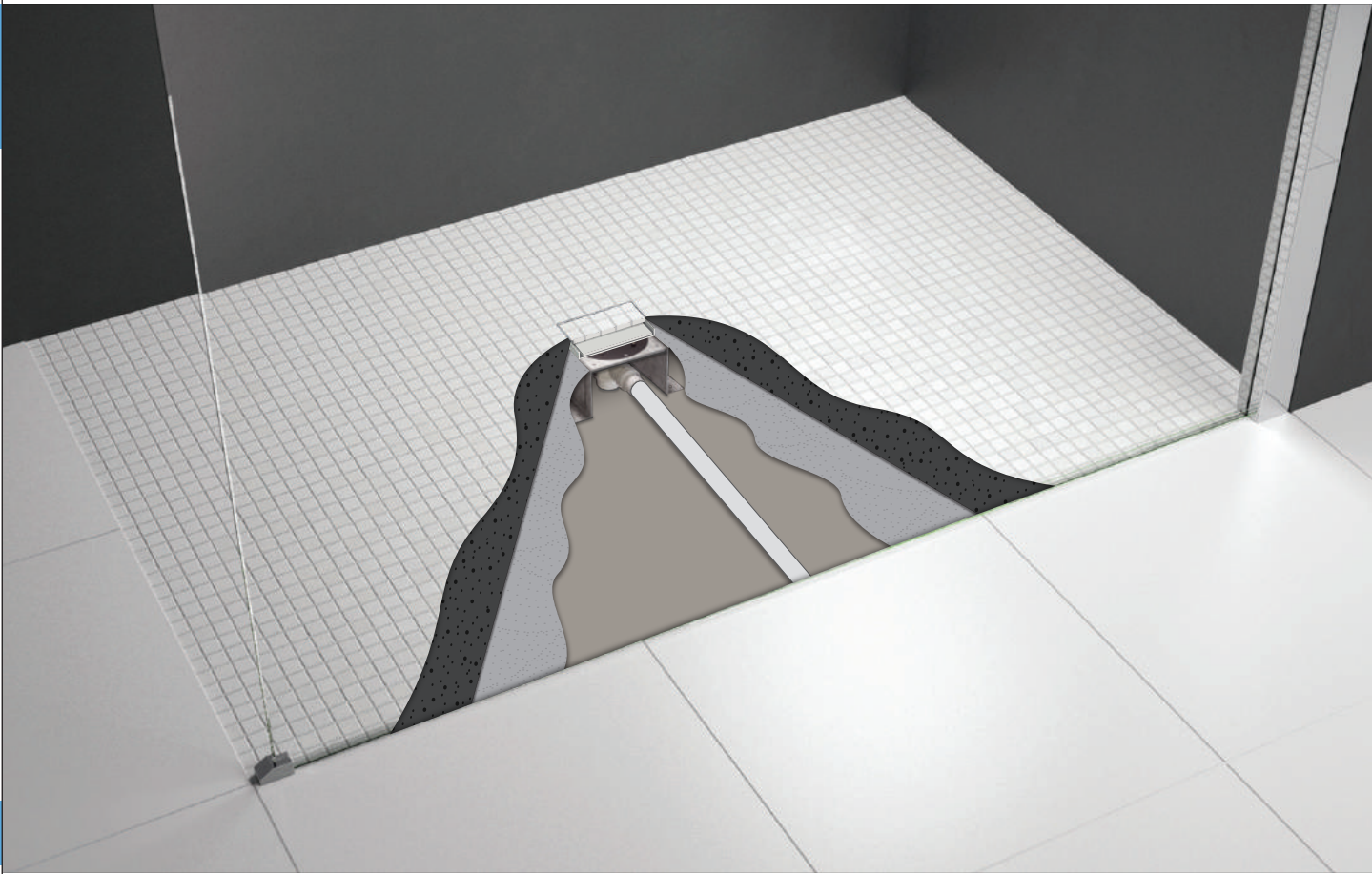

WATERPROOFING

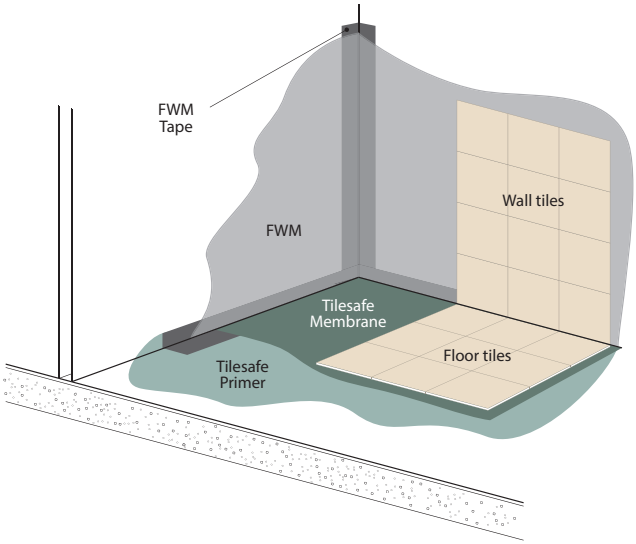

Waterproofing is one of the key elements of any wetroom, ensuring the room remains watertight at all times. To ensure your project is fully covered by our Lifetime Guarantee we have developed a range of unique waterproofing solutions, specifically designed and guaranteed to work with our Solo4 drain, to provide a complete solution and total peace of mind.

- Floor and wall membrane
- De-coupling properties
- Acoustic properties
- Quick and easy to apply
- Lifetime Guarantee

See Section 3 for full details.

PRODUCT CODES - DRAIN BODY

DRAIN BODY WITH HORIZONTAL TRAP



BRACKET	DRAIN & FLOW RATE	TRAPS	CODE
standard	 24 L / min	1	S4D-H/ST

DRAIN BODY WITH VERTICAL TRAP



BRACKET	DRAIN & FLOW RATE	TRAPS	CODE
standard	 24 L / min	1	S4D-V/ST



extra shallow	 24 L / min	1	S4D-V/ES
---------------	--	---	----------

PRODUCT CODES - GRILL

SQUARE GRILL



SIZE	CODE
130 x 130mm	S4D-SG/A



130 x 130mm	S4D-SG/B
-------------	----------



130 x 130mm	S4D-SG/S12
-------------	------------

TYPICAL DETAIL

- Horizontal or Vertical Outlet
- 50mm Waterseal trap EN274-1:2002
- Flow rate up to 24 L/min
- Lifetime Guarantee
- 360° Rotatable outlet
- Adjustable trap outlet
- Height adjustable brackets
- Height adjustable grill and choice of finishes

STANDARD BRACKETS - HORIZONTAL

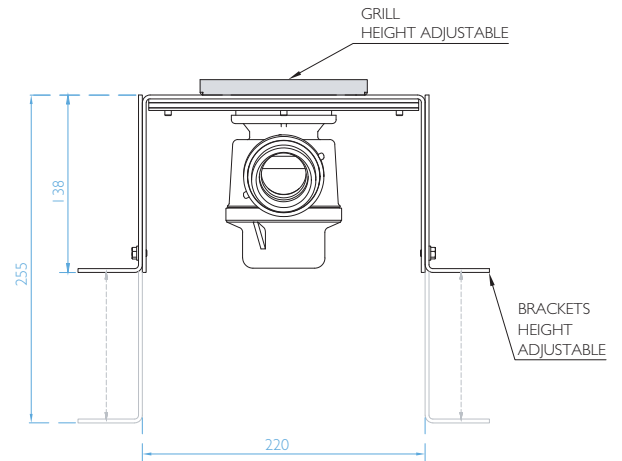

STANDARD BRACKETS - VERTICAL

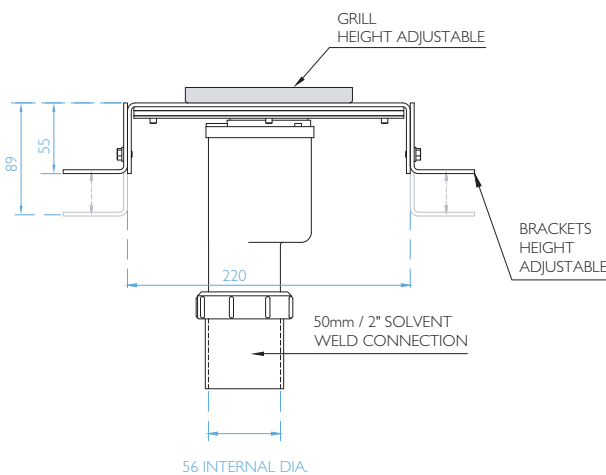

EXTRA SHALLOW BRACKETS - VERTICAL

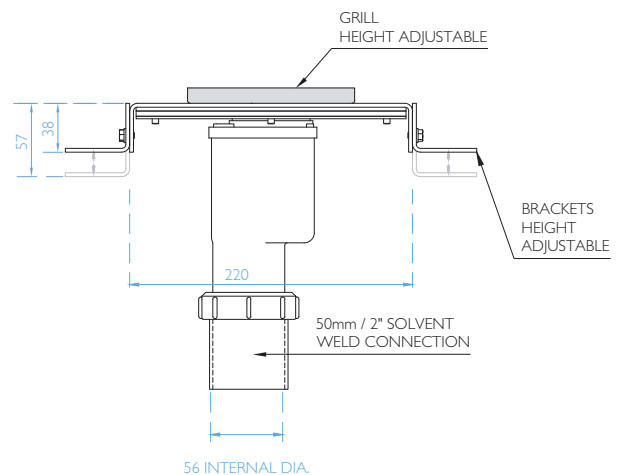

PLAN VIEW - HORIZONTAL TRAP

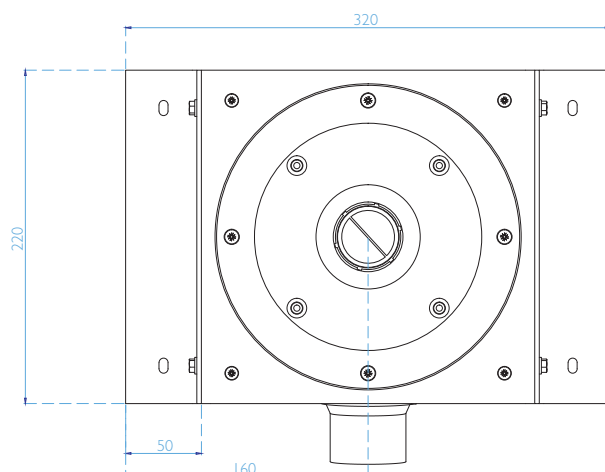

PLAN VIEW - VERTICAL TRAP

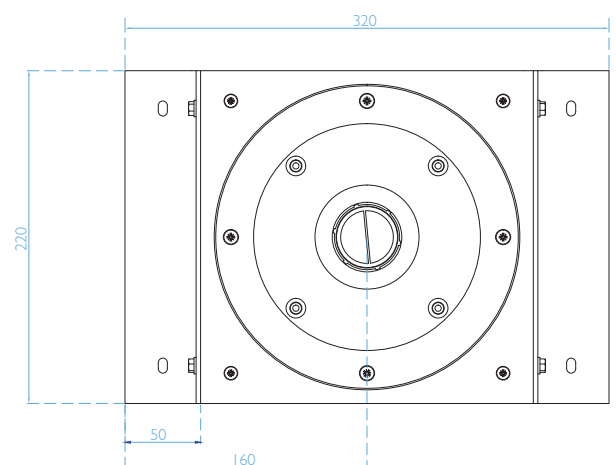

TYPICAL DETAIL

SOLID
FLOOR

FLOOR BUILD UP - STANDARD BRACKETS - HORIZONTAL

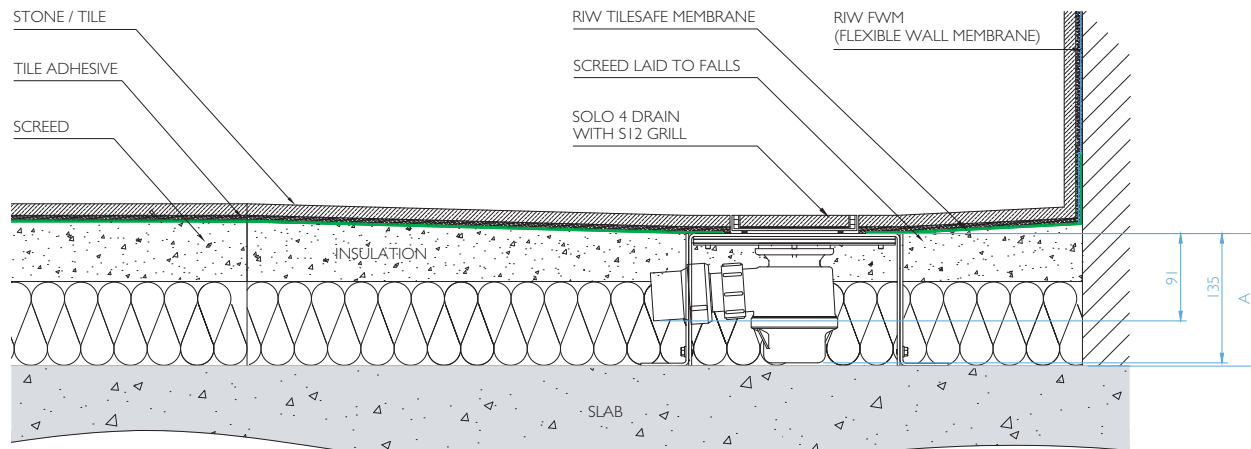

DIMENSION A : MIN. 138mm MAX. 255mm
(Extension brackets available) drawn as 138mm.

FLOOR BUILD UP - STANDARD BRACKETS - VERTICAL

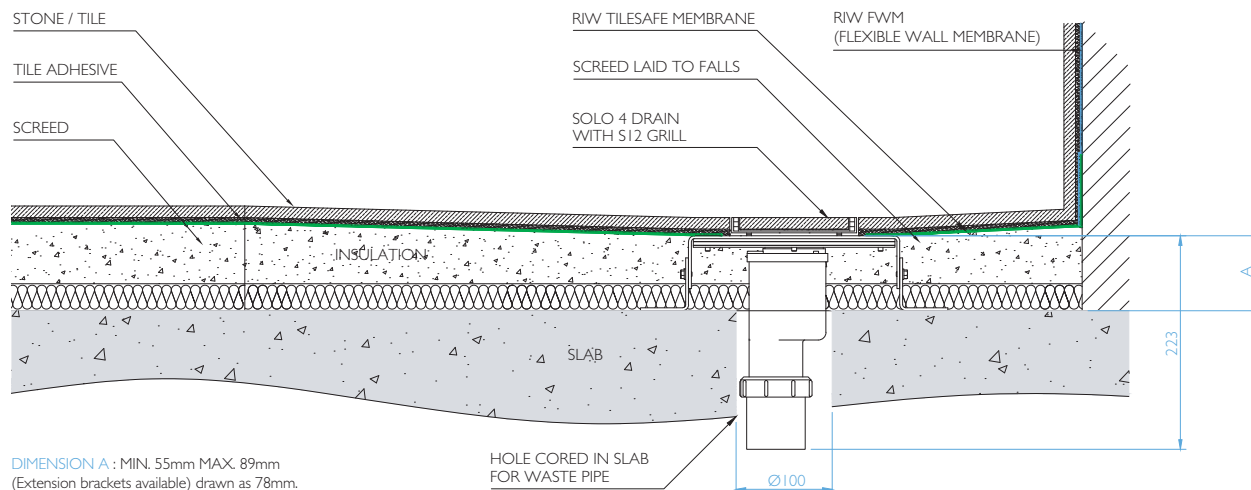

DIMENSION A : MIN. 55mm MAX. 89mm
(Extension brackets available) drawn as 78mm.

FLOOR BUILD UP - EXTRA SHALLOW BRACKETS - VERTICAL

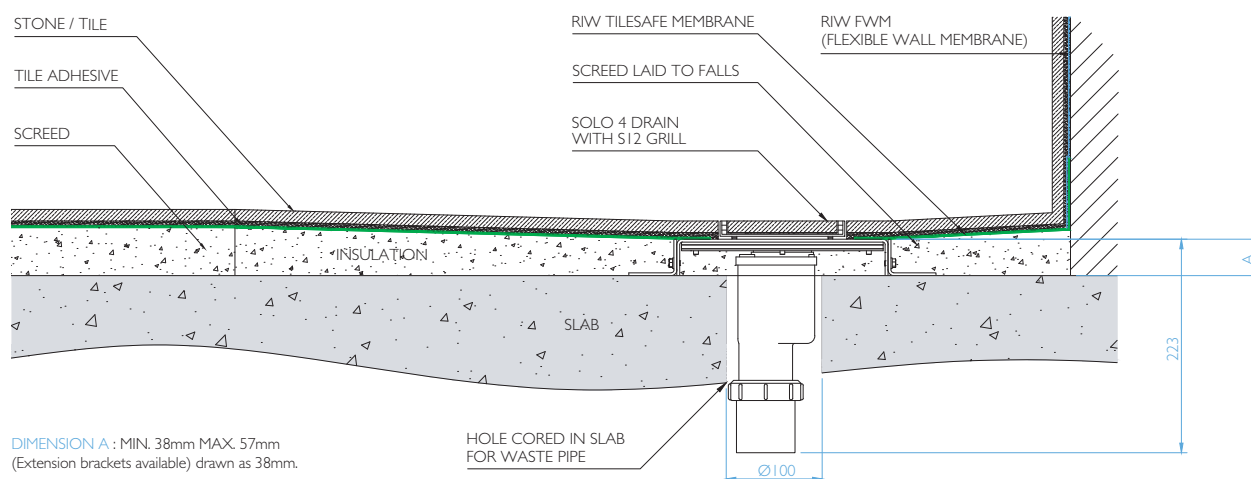

DIMENSION A : MIN. 38mm MAX. 57mm
(Extension brackets available) drawn as 38mm.

TECHNICAL ENQUIRIES

TEL: 0844 327 6002

technical@ccl-wetrooms.co.uk
www.ccl-wetrooms.co.uk

CCL Specialist Supplies Ltd

Lodge Farm
Hook Road
North Warnborough
Hook
RG29 1HA



TECHNICAL SUPPORT

For technical assistance please contact our experienced technical department who will be happy to assist in the following:

- Project design
- Product specification
- CAD drawings
- Method statements

TECHNICAL SEMINARS

We are able to provide CPD based seminars designed to provide guidance on key wetroom design considerations such as:

- Design and layout
- Drainage
- Waterproofing
- Flow rates

For further information please contact our technical department.

TECHNICAL ADVICE

Our team of technical advisors are able to visit you to provide a professional advisory service and assist with project design and specification.

We are also able to attend site to provide technical support and assistance.

INSTALLATION ENQUIRIES

TEL: 0845 045 6001

enquiries@wetroomsuk.co.uk
www.wetroomsuk.co.uk

Wetrooms UK Ltd

Lodge Farm, Hook Road
North Warnborough
Hook
RG29 1HA

INSTALLATION

With over 30 years experience in the waterproofing industry, our involvement in a project from conception to completion ensures that quality is never compromised.

Our services include:

- Design and installation
- 10 Year Insured Installation guarantee
- On-site training



PEACE OF MIND
GUARANTEED

